



35 Rainbow Drive , Atherton, M46 9ND

Two bedroom end townhouse property, well located for local amenities, rail and all network links. Briefly comprising of spacious lounge, dining kitchen, two bedrooms and a family bathroom. Offered with no onward chain. Early viewing highly advised.

Offers Over £120,000

35 Rainbow Drive

, Atherton, M46 9ND



- TWO BEDROOM END TOWNHOUSE
- DINING KITCHEN
- GAS CENTRAL HEATING
- ENCLOSED REAR GARDEN
- FULLY DOUBLE GLAZED
- DRIVEWAY

LOUNGE

12'4" x 12'11" (3.76 x 3.94)

DINING KITCHEN

8'2" x 12'11" (2.49 x 3.94)

STAIRS & LANDING

BEDROOM ONE

8'10" x 6'5" (2.70 x 1.96)

BEDROOM TWO

11'7" x 12'11" (3.55 x 3.94)

BATHROOM

5'6" x 6'2" (1.69 x 1.88)

EXTERIOR FRONT

EXTERIOR REAR

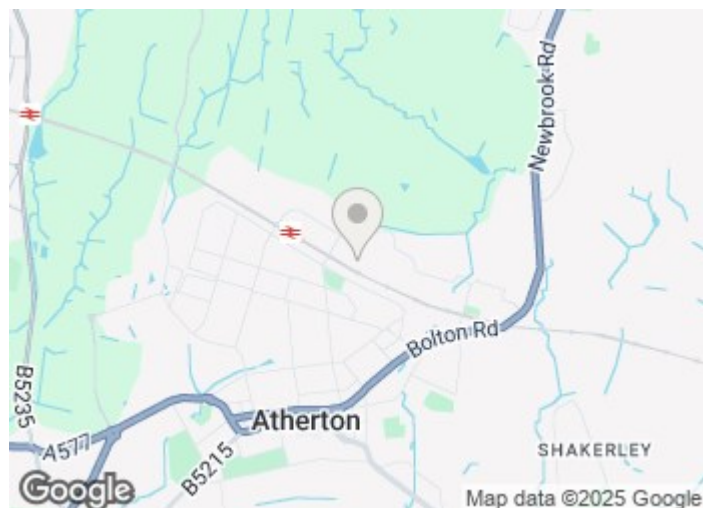

[Directions](#)





Floor Plan

Ground Floor

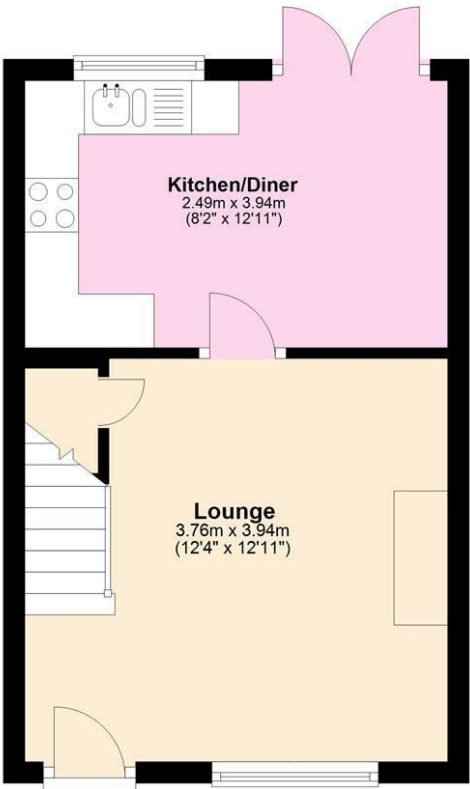

First Floor

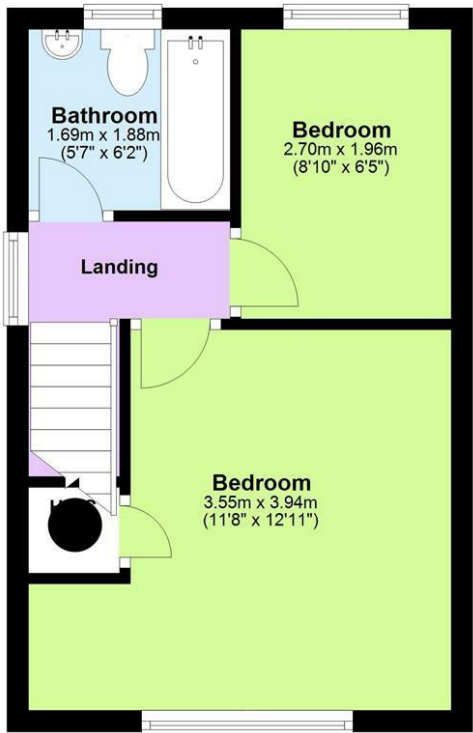

Total area: approx. 50.0 sq. metres (538.6 sq. feet)

These particulars, whilst believed to be accurate are set out as a general outline only for guidance and do not constitute any part of an offer or contract. Intending purchasers should not rely on them as statements of representation of fact, but must satisfy themselves by inspection or otherwise as to their accuracy. No person in this firms employment has the authority to make or give any representation or warranty in respect of the property.

